

POCONO MANOR

Located 3 Miles W. of Mt. Pocono

MAY 1928
MOUNTPOCONO
PA.

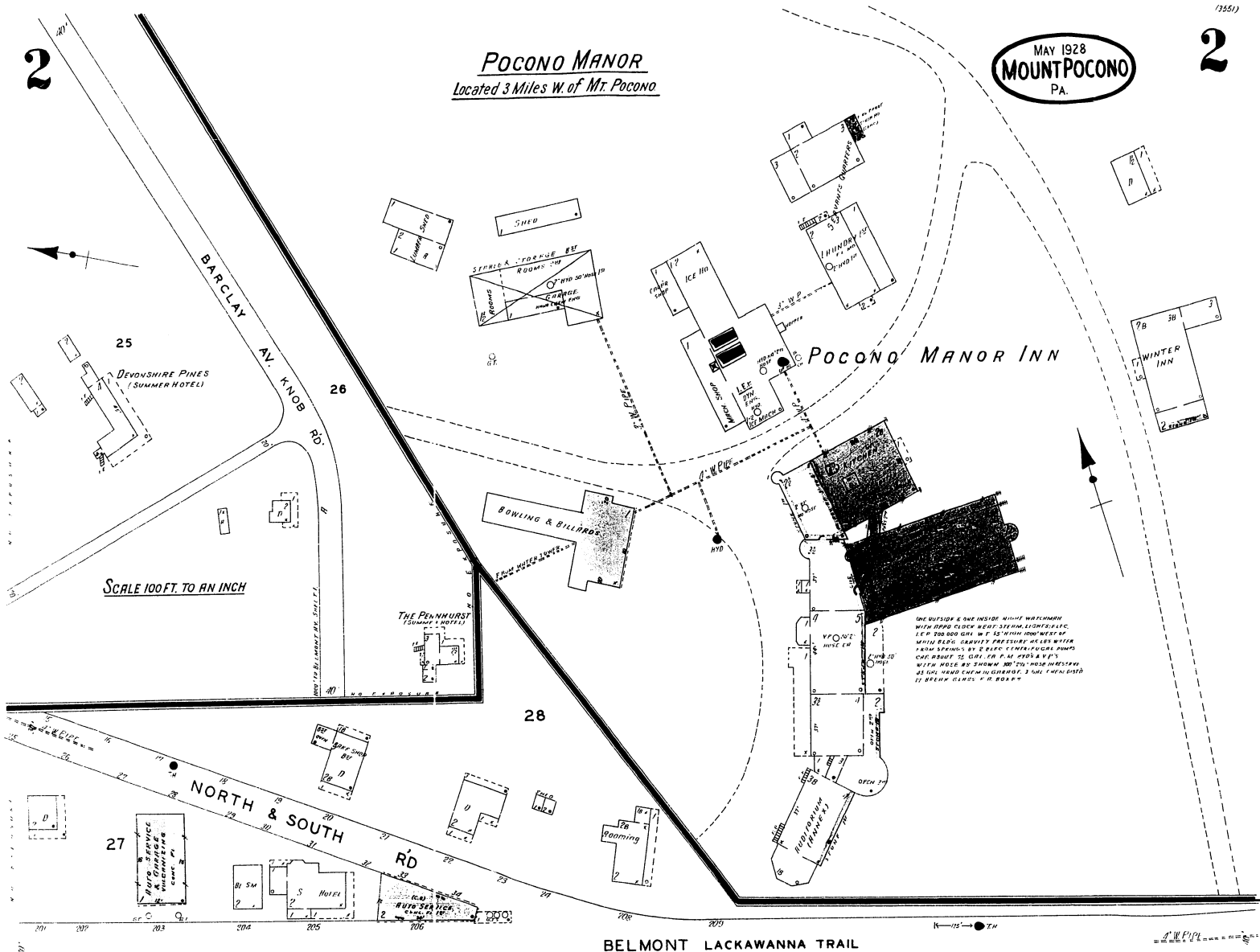

ONE OUTSIDE & ONE INSIDE NIGHT WATCHMAN WITH HAND CLOCK NEAR STERN LIGHTER L.C. LEFT DOOR DOOR ONE IN P. 15' WITH DOOR NEAR MAIN REAR. GARBIT PRESSURE AS LES WATER FROM SPRING BY 2 BAR. CENTER FOR ONE DOOR. ONE ABOUT 12 GAL. IN P. 15' & V.P.'S WITH HOSE AS SHOWN 300' TO POSE PRESSURE AS ONE HOSE ONE IN GROUND. 3 HOSE PENETRATED 17 BREAK GLASS & 18 BOX

